

Introduction

The strainer with manual shut off is a coarse filter for coolant mixture of water and antifreeze. It consists of a water valve with integrated filter screen all in one housing. The shut off function enables easy replacing/cleaning of filter.

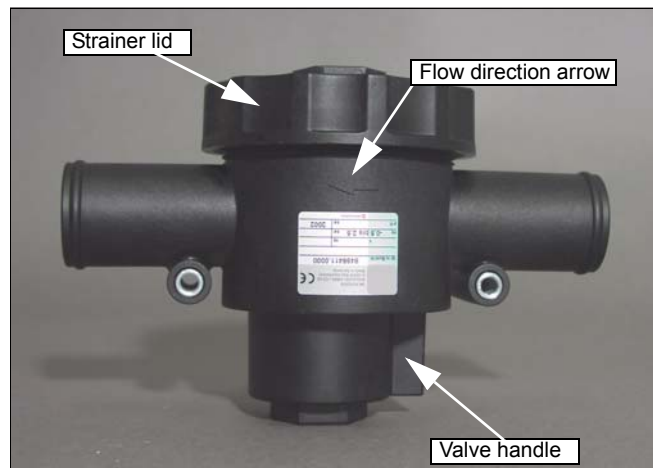

Attach the valve according to the photo right with the lid up and the direction of flow according to the arrow!



Technical Data

Description

Switching function	Manual shut off
Flow direction	Determined
Fluid temperature	-30°C - +90°C
Ambient temperature	-30°C - +90°C
Mounting position	Filter housing vertical underneath
Filter mesh size	0,32mm

Characteristic data:

DN (mm)	25mm
Connection	38mm
Operating pressure with Fluids up to 40 mm/s (cSt) (bar)	-0,5 (min) 2,5 (max)
Kv-value	15
Weight (kg)	0,5

Material:

Body	PA66
Seals	EPDM
Internal parts	PA66, 1.4301

Dimensions (mm)

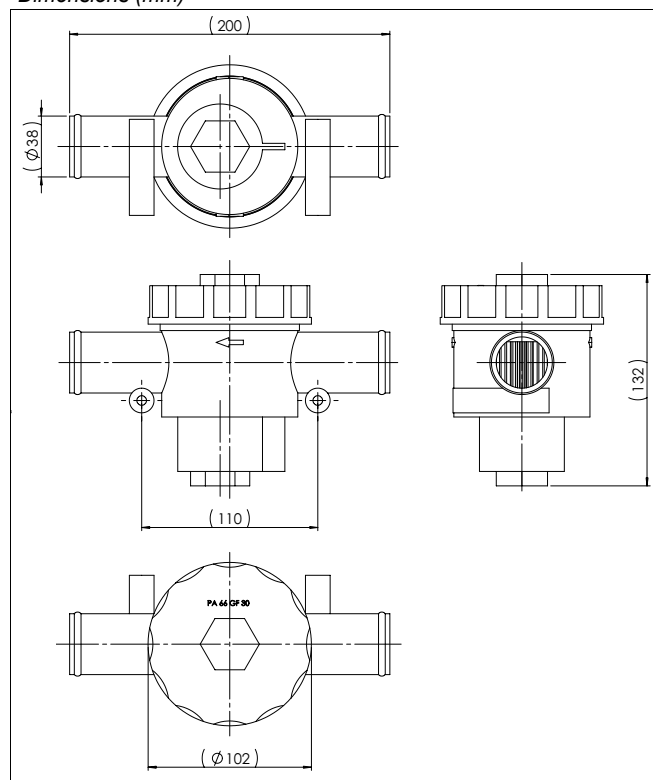

Water filter change

The water filter/strainer is easily changed/cleaned thanks to the integrated shut off valve. Just turn the valve handle clockwise to close it (figure 1). Then just unscrew the lid and lift it off (figure 2) and lift up the water filter (figure 3). If it needs to be changed, order a new one from UWE, see part number next page.

Having the strainer cleaned just put it back again, make sure that the O-ring is in place and then tighten the lid. If the O-ring is damaged, order a new one, part number next page.



NOW Don't forget to open the valve, and look for eventual leakages!

Figure 1

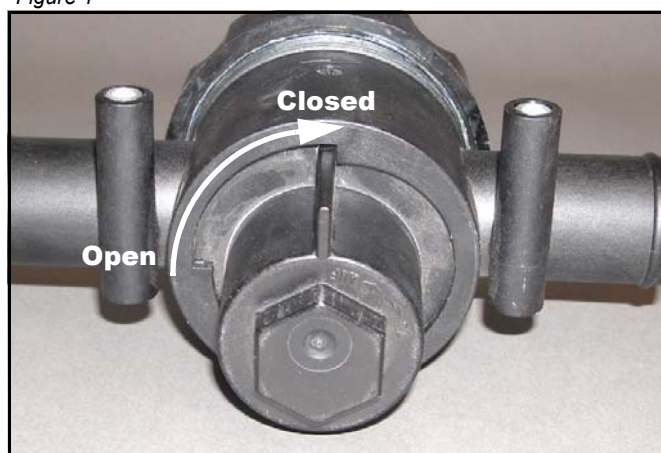

Figure 2



Figure 3



Range

Name	Part no.
Strainer with manual shut off valve	16487

Spare parts

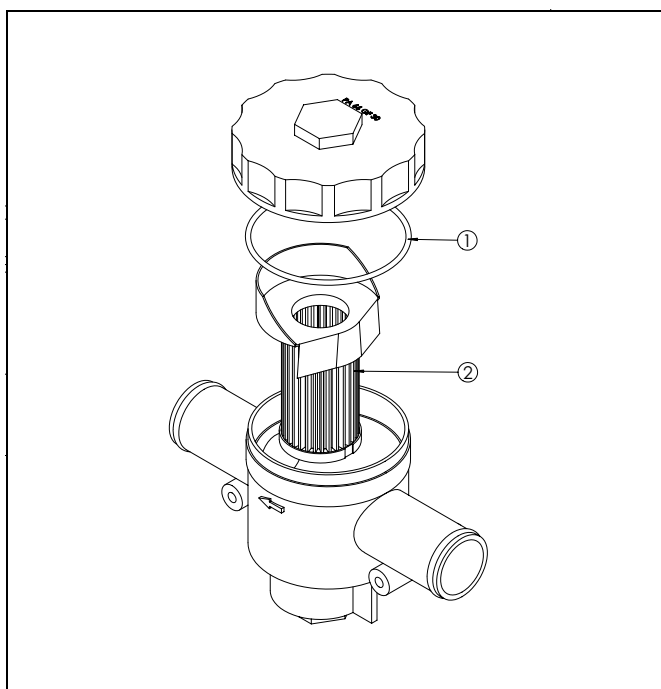

Name	Part no.
1. O-ring	16487-01
2. Strainer	16487-02

UWE Verken AB
 Box 262
 S-601 04 Norrköping, Sweden
 Phone +46 11 24 88 00
 Fax +46 11 12 47 04
www.uwe.se

